

LumEfficient
Resilient LED



DTD Series

AREA LIGHTING

FEATURING LIGHT EMITTING DIODE (LED)

Benefits

- 105 Lumens Per Watt
- IP65 rating for entire fixture
- Integral 10kV surge protection
- Capable of 0-10V analog dimming
- Available with photocell option
- Available with PC diffused lens for minimal glare
- 7-year warranty



Application Areas

- Roadway
- Security
- Dusk to Dawn
- Area Lighting



Compliance

- UL1598 for marine grade environments
- 10kV surge suppression



IP65

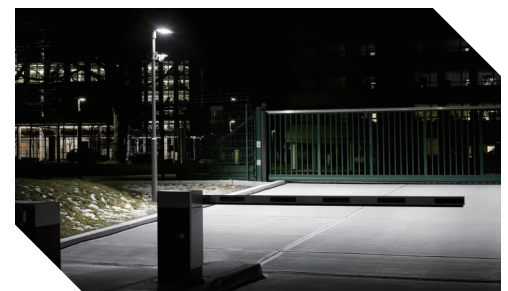

OUR SERVICES

Site Evaluation

Application Consulting

Installation Support

LumEfficient
Resilient LED

INFO@LUMEFFICIENT.COM / WWW.LUMEFFICIENT.COM

SUBJECT TO CHANGE
v2303

FEATURES

Input Voltage	120 - 277V (50/60 Hz)
Power Factor	> 0.98
Total Harmonic Distortion (THD)	< 20%
Surge Protection	10kV suppression
Operating Temperature	-30°C to +40°C
Mounting	Slip fitter adjustable for 1-1/4" to 2-3/8" pipe
Housing	Die cast aluminum
Finish	Polyester powder coating

DIMENSIONS (inches)

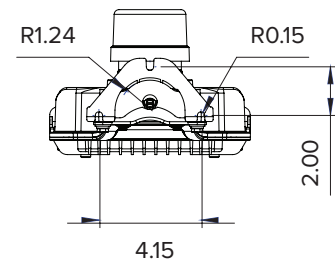
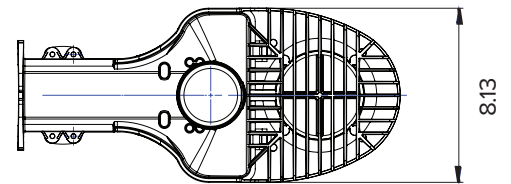
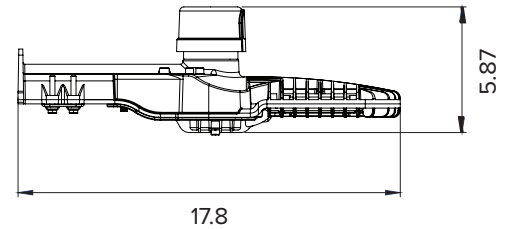

OPTICS

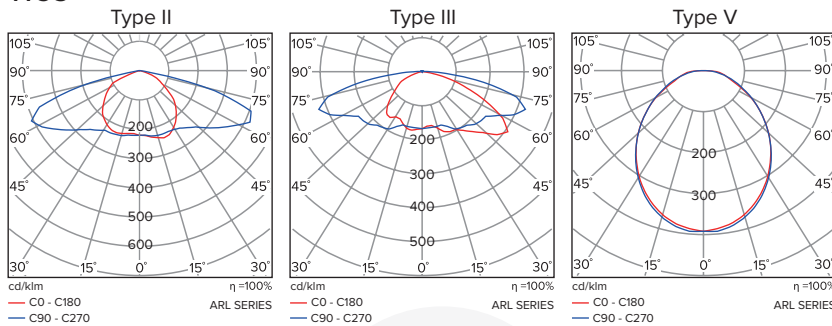

SPECIFICATIONS

	57W
Initial Lumens	5,985
Lumens Per Watt	105
Lumen Maintenance (L70)	50,000
Total Current at 120V (A)	0.46
CRI	75
CCT (K)	4,000K
Weight	6lb (2.72kg)

ORDERING OPTIONS

Sample Order Code: DTD0100-T5-V1-R-P-50

Family	Optics	Voltage	Control	Mounting	Wattage
DTD0100	(T2) Type II (T3) Type III (5) Type V	(V1) 120-277V	(P) Photocell and Receptacle (R) Receptacle Only	(P) Pole	(50) 50W