



## ARL SERIES

### AREA LIGHTING

FEATURING LIGHT EMITTING DIODE (LED)

#### Benefits

- 96 Lumens Per Watt (4,000K)
- IP65 rating for entire fixture
- Integral 10kV surge protection
- Capable of 0-10V analog dimming
- Available with photocell option
- Available with PC light diffusion lens for no glare
- 7-year warranty



#### Application Areas

- Roadway
- Security
- Dusk to Dawn
- Area Lighting



#### Compliance

- UL1598 for marine grade environments
- 10kV surge suppression



**IP65**



#### OUR SERVICES

Site Evaluation

Application Consulting

Installation Support

## FEATURES

<b>Input Voltage</b>	120 - 277V (50/60 Hz)
<b>Power Factor</b>	> 0.98
<b>Total Harmonic Distortion (THD)</b>	< 20%
<b>Surge Protection</b>	10kV suppression
<b>Operating Temperature</b>	-30°C to +40°C
<b>Mounting</b>	Slip fitter adjustable for 1-1/4" to 2-3/8" pipe
<b>Housing</b>	Die cast aluminum
<b>Finish</b>	Polyester powder coating

## DIMENSIONS (inches)

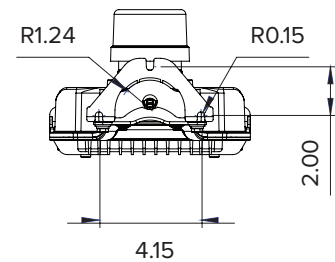
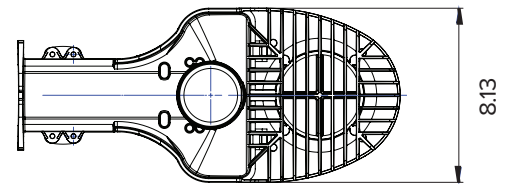
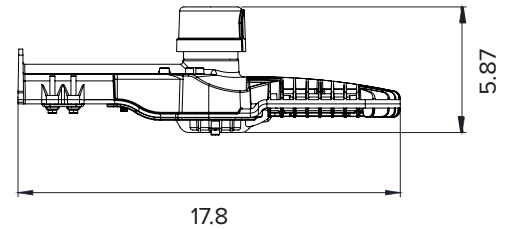

## OPTICS

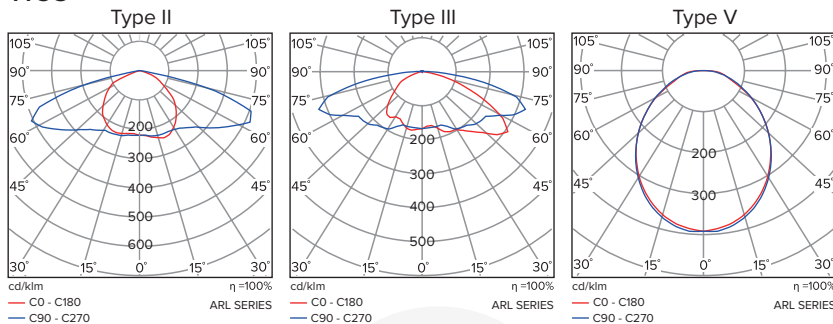

## SPECIFICATIONS

	<b>57W</b>
<b>Initial Lumens</b>	<b>5,479</b>
<b>Lumens Per Watt</b>	<b>96</b>
<b>Lumen Maintenance (L70)</b>	<b>50,000</b>
<b>Total Current at 120V (A)</b>	<b>0.46</b>
<b>CRI</b>	<b>75</b>
<b>CCT (K)</b>	<b>4,000K</b>
<b>Weight</b>	<b>6lb (2.72kg)</b>

## ORDERING OPTIONS

*Sample Order Code: ARL0100-T3V1PP20*

Family	Optics	Voltage	Control	Mounting	Wattage
ARL0100	(T3) Type III	(V1) 120-277V	(P) Photocell and Receptacle	(P) Pole	(50) 50W
	(T2) Type II				
	(T3) Type III				
	(5) Type V				
	(T2) Type II				