

# RESILIENT

## TOUGH LIGHT

A LUMA BRAND

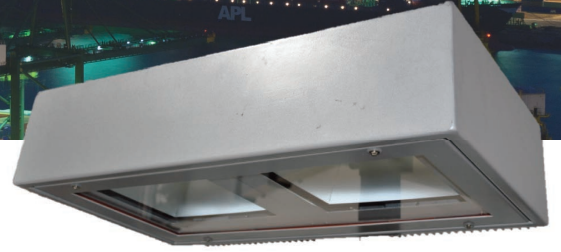

## HMP1100 SERIES

### HIGH MAST LIGHTING

FEATURING LIGHT EMITTING PLASMA (LEP)

#### Benefits

- High output plasma (LEP) light source
- Full spectrum white light
- Available with wireless controls
- Lightweight, wind resistant, IP65 rated housing design
- Dimmable from 100% to 20%
- 5 year warranty



#### Application Areas

- Ports
- Airport Aprons
- Parking Areas
- Highways
- Railway Yards



#### Compliance

- UL1598A listed for marine grade environments
- 10kV surge suppression in accordance to IEEE/ANSI C62.41.2



**IP65**

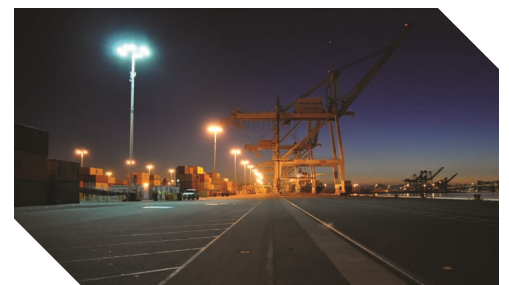

#### OUR SERVICES

Site Evaluation

Application Consulting

Installation Support

**RESILIENT**  
TOUGH LIGHT

SALES@RESILIENT.LIGHTING / [WWW.RESILIENT.LIGHTING](http://WWW.RESILIENT.LIGHTING)

**PRELIMINARY**  
SUBJECT TO CHANGE

# HMP1100 SERIES

# HIGH MAST LIGHTING

FEATURES	
Power Factor	> 0.94
Total Harmonic Distortion (THD)	< 20%
Surge Protection	10kV suppression (IEEE/ ANSI C62.41.2)
Operating Temperature	-40°C to +50°C
Mounting	Fits to pole on 2-3/8" mast arm fitter with ±15° tilt
Housing	Die cast aluminum
Finish	Polyester powder coating
Lens	Clear tempered high-transmission anti-reflective glass
EPA	1.5ft <sup>2</sup> (1-way)

## DIMENSIONS (inches)

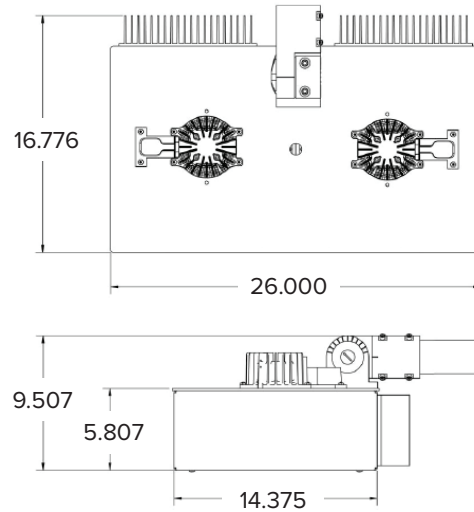

## OPTICS

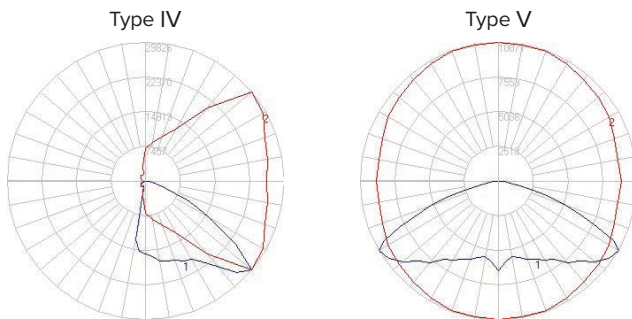

SPECIFICATIONS	STA-41-01
Initial Lumens	46,000
Watts	540
Lumen Maintenance (L70)	50,000
CRI	72
CCT (K)	5,200
Weight	45lb (20.4kg)

## ORDERING OPTIONS

Sample Order Code: **HMP1100-411-T4-V1-0-K**

Family	LEP Series	Optics	Voltage	Options	Mount
HMP1100	(411) STA-41-01	(T4) Type IV (T5) Type V	(V1) 120-277V (V3) 347-480V	(0) None (W) Wireless (P) Photocell and Receptacle (R) Receptacle Only	(K) 2-3/8" Knuckle